



rebuildglobal®

Portfolio

“Rebuild Global represents an exciting new force in design. Because it works as thoughtfully and energetically with social architecture as with physical, it exemplifies design sensibility at its best. We desperately need this kind of organization to redesign the seriously flawed infrastructure of every part of our society. Rebuild Global has what it takes.”

Richard Farson, President, Western Behavioral Sciences Institute
Psychologist and Author of “The Power of Design”





The physical design of our homes, neighborhoods and communities shapes every aspect of our lives. Yet too often architects are desperately needed in the places where they can least be afforded.

~ Cameron Sinclair, co-founder, Architecture for Humanity

MISSION

In 2010, Rebuild Global was established as a nonprofit organization whose mission is **to deliver socially responsible and sustainable architecture and design solutions where they are unavailable and needed most.**

By challenging designers to work with communities, we solve problems in innovative ways using our creative expertise and volunteer network to execute smart solutions. We gauge our success by the growth of the organization and the influence we have on encouraging designers to engage more actively as leaders and to elevate the power and influence of design on our society.

We partner architects, landscape, interior and community planners with non-governmental, nonprofit and community based organizations to service low-income and marginalized communities.

The founders of Rebuild Global, have been delivering this mission since 2004, first as the San Diego chapter of Architecture for Humanity, and now as a 501c3, nonprofit organization. During that time, we have completed a number of noteworthy projects, servicing low income communities, homeless populations, natural disaster survivors and the disabled.

Rebuild Global is built on two simple principles: to provide design and construction resources where they are scarce and needed most, and to cultivate a movement of compassion and service within the design community.

GLOBAL ASSISTANCE

Rebuild Global realizes the power and benefit that design can have on struggling communities. We partner with non-profits and community organizations around the world to make a difference. Design students and professionals select from a number of projects, fund-raise to travel abroad, and then spend either two weeks or an entire summer bringing that project to life.

DESIGNER MATCH

Rebuild Global provides outlets for socially responsible designers to give back to their community and for local organizations to connect with much needed volunteer professionals. Architects and designers enroll in the designer match program and commit a fixed number of pro-bono hours to local non-profits. Non-profits complete a request for services at rebuildglobal.org and we match the right designer to projects which benefit local communities.

GREEN GARDENS GROW

School gardens teach students healthy eating habits, environmental stewardship, and real life lessons on the rewards of hard work. Rebuild Global works with local schools to make their dream gardens come to life. We provide design expertise, project management, and assistance with project funding.

learning³ a classroom competition to redesign the classroom of the future



existing modular classrooms at palmquist elementary



unused space

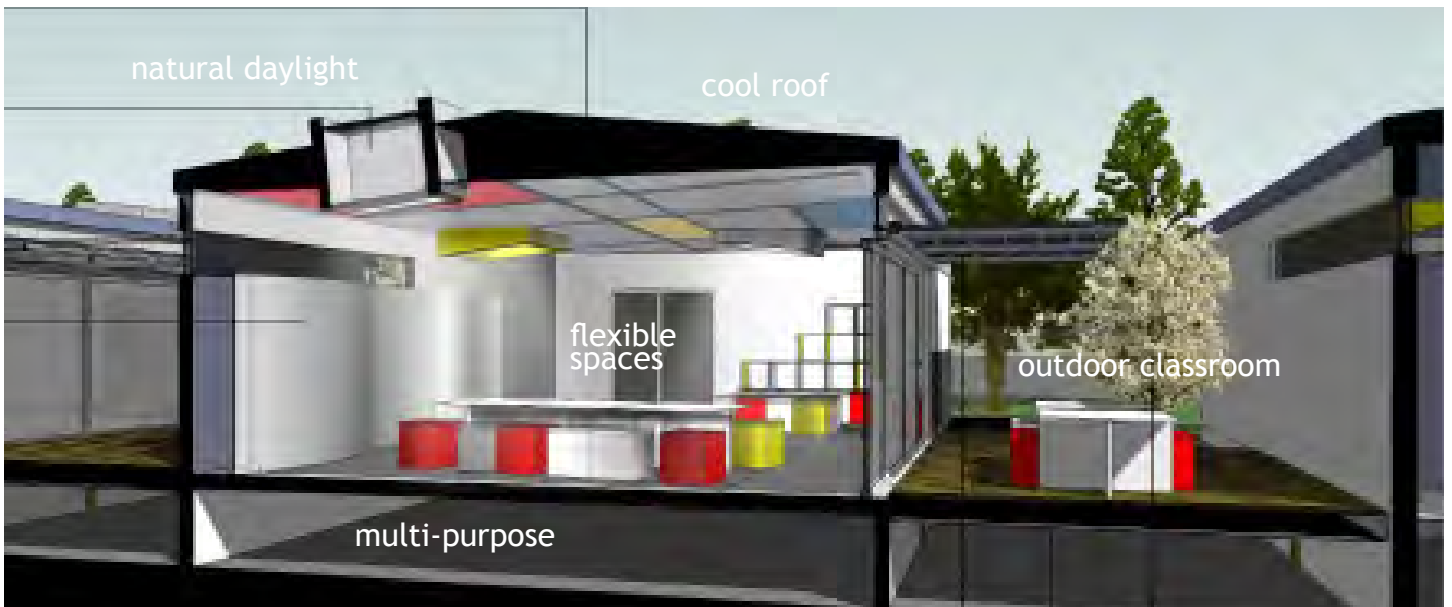

design proposal: a learning laboratory used by multiple teachers and students throughout the day



classroom of the future

split.shift.rectangle

housing solutions for Tijuana, Mexico



existing housing conditions



existing site conditions



design proposal: providing cost effective alternative housing solutions per community discussions



alternative housing solutions

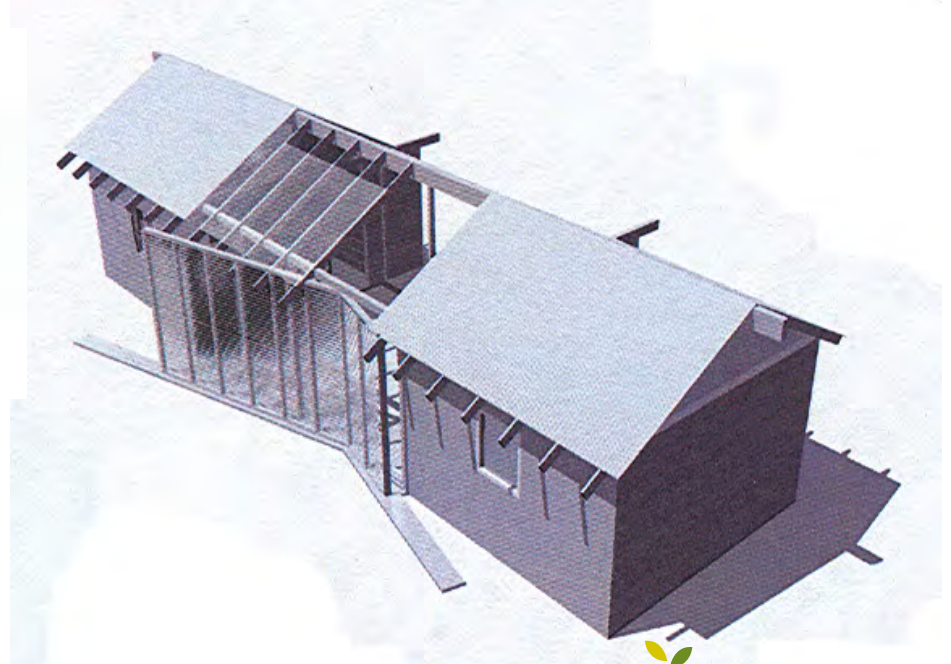

green gardens grow

a school garden network

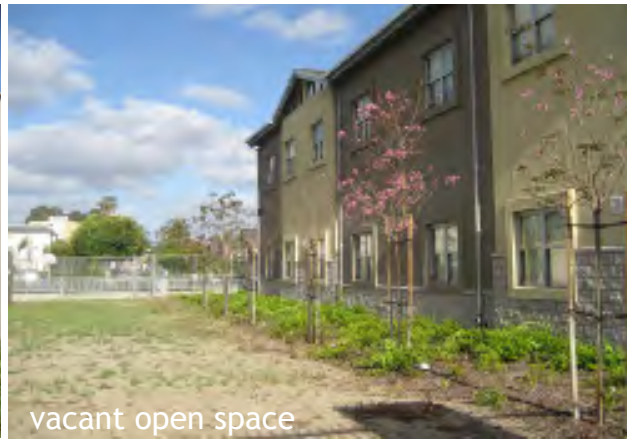

design proposal: a unique environment for garden-based learning for students and teachers alike

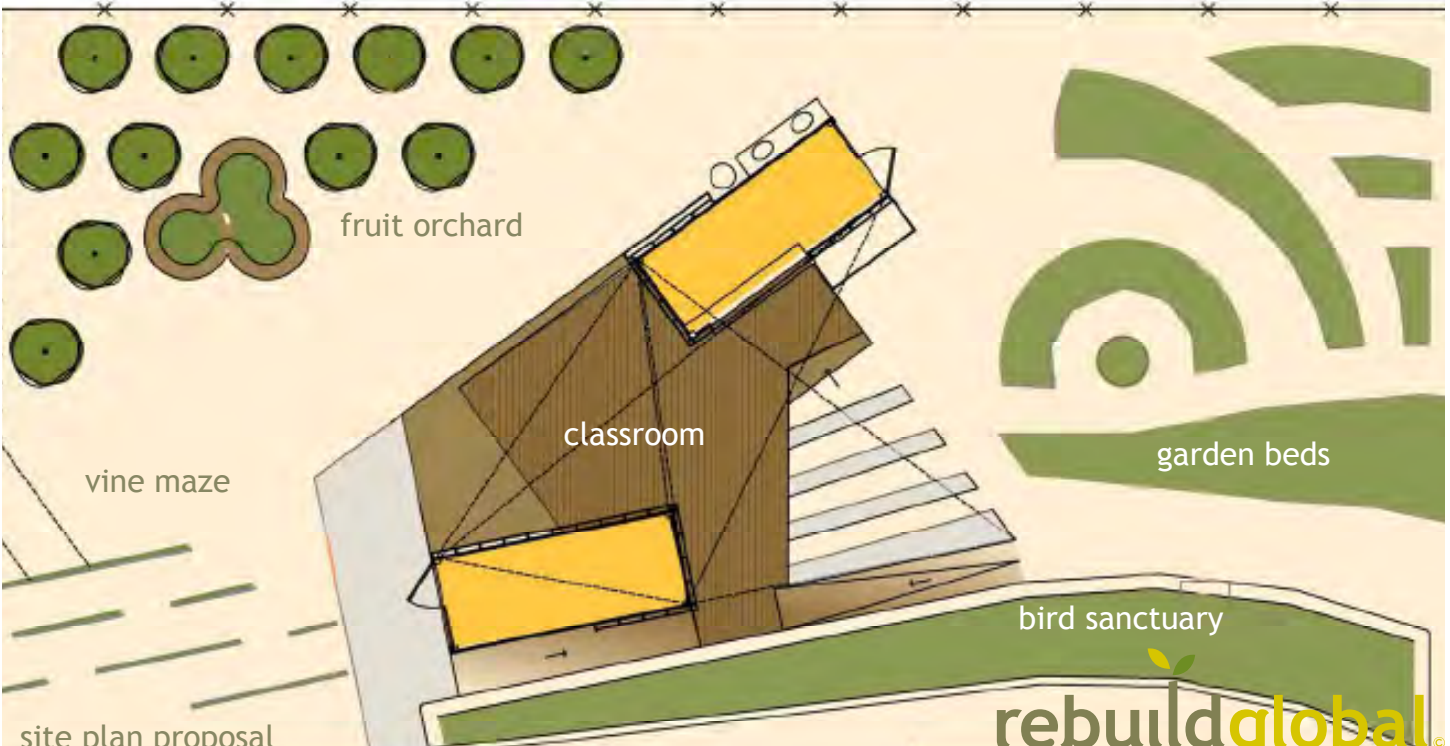

green gardens grow

a school garden network



existing site conditions at washington elementary



vacant open space



edible plants

outdoor classroom

greenhouse

vertical garden

strawbale bench

fruit trees

vegetables

design proposal: a school garden network that educates students on the benefits of eating healthy



ground-breaking: november 2010



6
Years in
the Community



475
Newsletter
Subscribers



12,480
Volunteer
Staff Hours



7,655

Donated Service Hours



26

Partnering Organizations



1

World To Change

PARTNERING ORGANIZATIONS

American Institute of Architecture Student Association
Architecture for Humanity
California Center for Sustainable Energy
California Institute of Earth Art and Architecture
California Parks and Recreation – Orange Coast District
Crawford High School
Engineers without Borders
First Step Domestic Violence Shelter
Foundation for Form
Fuller Center for Housing
Heartland Foundation
International Humanity Foundation
Master Gardeners
Matthew Sherman Elementary
Mission Bay High School
Newschool of Architecture and Design
Nike West Corporate Responsibility
Operation Crossroads Africa
Palmquist Elementary School
San Diego Architectural Foundation
San Onofre Foundation
Stand Up for Kids
The Global Studio
United Green
Victory Gardens
Washington Elementary

TESTIMONIALS

“Rebuild Global’s individual energies, collaborative efforts and global perspective serve as an inspiring model of a new work order focused on positive change, one community at a time. Their humanity and resolve all but ensure the realization of their mission; that is, simply put, to make the world a better place.”

**Leslee Schaffer, Executive Director,
San Diego Architectural Foundation**

“Washington Elementary is the perfect place for an urban garden, building this garden will bring together our students, parents and community members by providing a project that beautifies the school and teaches us about our food sources and our environment.”

**Janie Wardlow, Principal,
Washington Elementary**

rebuildglobal.

241 14th Street, San Diego, CA 92101
info@rebuildglobal.org | 619.796.4796
www.rebuildglobal.org

